

# POWERTOOLS

PowerTools are a set of important tools fully integrated with the last version of SolidWorks. Its goal is to improve productivity on the daily tasks and improve the connection to manufacturing through automation.

Metalomechanics' Design:

- 100% integrated on SolidWorks
- 100% focused on repetitive and time consuming tasks.

Creation of beams based on splines, with automatic length and weight calculation.

Input of Excel based lists of points for Measurement Control or for Production.

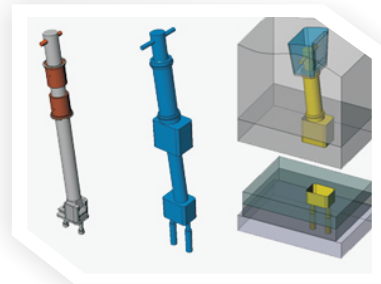

[www.althima.com](http://www.althima.com)

# POWERTOOLS



Automatically creates DXF files of the flatten part for all parts of an assembly. Raw material consumption is calculated.

Working folder capabilities. Files are copied when dragged from the library.

Helices and Square-Circle transitions unfolding with bend lines for manufacturing purposes.

Imports holes from an Excel Spreadsheet.

Cavities on multiple parts, simultaneously.

# POWERTOOLS

## DO YOU KNOW...

"... that with POWERTOOLS, a single click is enough to create all DXF files of the flatten shape of all sheet-metal parts of an assembly, and calculate the minimum rectangle of those flatten parts? ..."

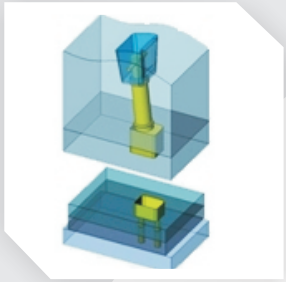
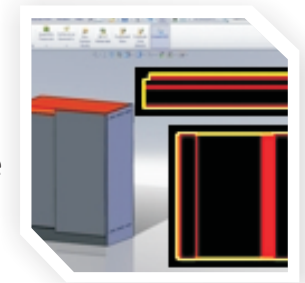

"... that with POWERTOOLS you can, with a single click, convert all parts, in all defined Coordinate Systems, on the assembly to IGES, STEP, Parasolid or SAT? ..."

"... that with POWERTOOLS you can calculate the Bounding Box of any part in any orientation?..."

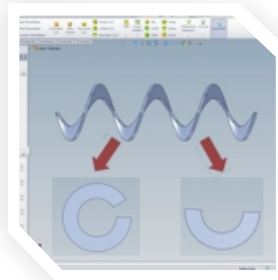
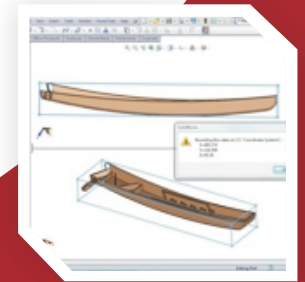

"... that with POWERTOOLS you can unfold Helices for manufacturing purposes? ..."



## WHO IS ALTHIMA?

Althima is a provider of high performance solutions that increase users productivity and, as consequence, the productivity of the company. Althima specialized in the area of computer graphics having experience in the integration of CAD/CAM/PDM applications and having also graphic interfaces of her own.

Addressing industrial areas like Ship Building, Wood Furniture, Process Equipment and Plant Design and with expertise in areas like bus frames, glass bottle molds and aluminum facades.

Our goal is to delivery high productive software through the SolidWorks resellers channel helping to improve their business and the end user productivity.

### Tailored solutions by Althima

Tif you don't see a product that fits your need exactly, we also have our Tailored Solutions service. Our applications engineers will work with your team to develop a solution that is tailored to fit your unique requirements.

Leverage from our experience and expertise, our knowledgeable experts can quickly understand where customers' problems lie, and what they really require. We design and develop solutions to drive success excellence towards customers..

